

# Spill Containment

## Multi-Port Phase I EVR

The **A1004EVR Multi-Port Spill Containers** are Phase I EVR approved and include the following features:

- 42-inch steel diamond plate lid with 16-inch tank bung spacing  
*Optional diamond plate lid in light weight aluminum*
- 6 cam-locks and dual lid handles for easy lock-down and removal
- 8-inch observation port w/ water-tight seals
- All mounting bolts non-corrosive stainless steel
- Manhole rim channel w/ D-seal for water tightness integrity between lid and rim
- Manhole available w/ 12-inch or 18-inch galvanized skirt
- Nominal spill container capacity of 5 US gallons
- Cast iron spill container base w/4-inch NPT thread connection  
*Requires no face seal adapter*
- Powder coated, heavy duty, cast iron lid and ductile iron plow ring, exceeds DOT H-20 loading  
*Optional lid in composite material*
- Lid w/ triple wiper seal
- HDPE primary spill container bellows
- Drain valve w/ filter or plug option
- Compatible with most water shrouds and boot kits

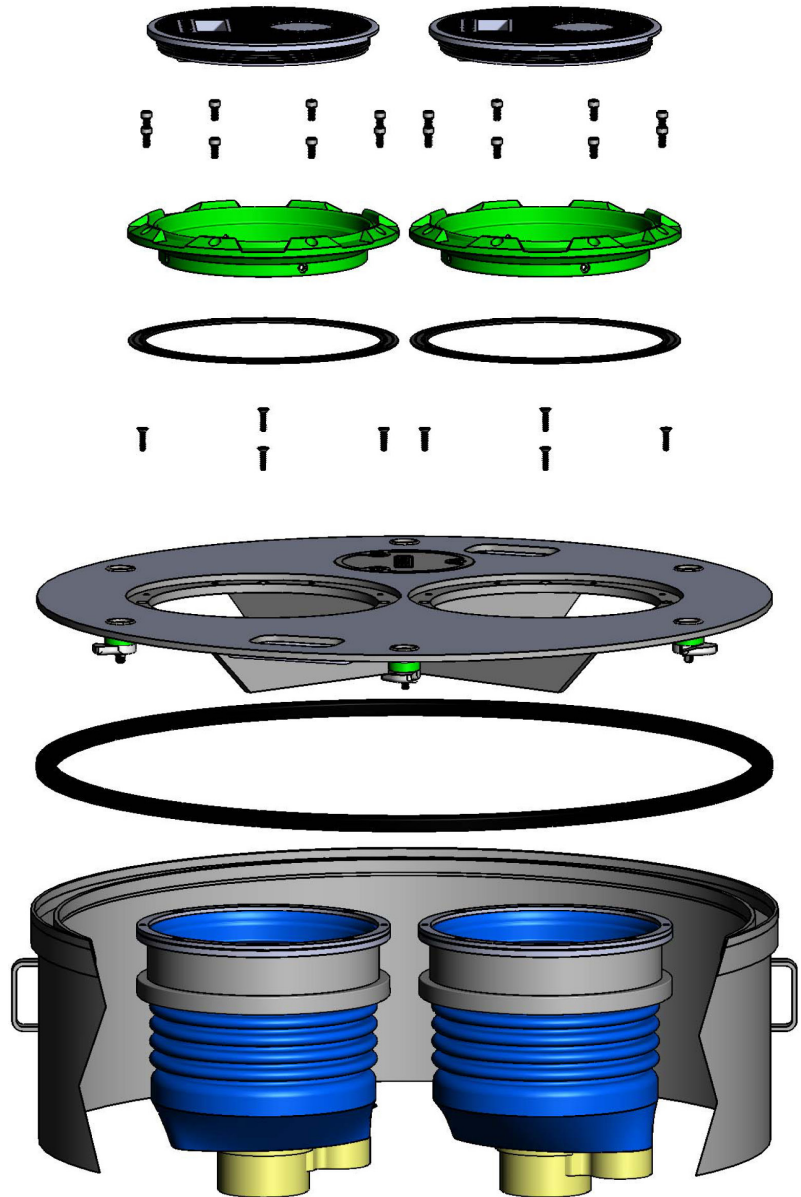

■ CARB Phase I EVR Executive Order VR-105

Model No.	Description	Spill Container #1	Drain Type	Spill Container #2	Drain Type
A1004EVR-2421D1A	42" Multi-Port MH, 8" Observation Port 12" Skirt, Gasoline	SW, 5 gal	Drain Valve	SW, 5 gal	No Drain
A1004EVR-242101A	42" Multi-Port MH, 8" Observation Port 12" Skirt, Gasoline	SW, 5 gal	No Drain	SW, 5 gal	No Drain
A1004EVR-2421D0A	42" Multi-Port MH, 8" Observation Port 12" Skirt, Diesel	SW, 5 gal	Drain Valve	None	N/A
A1004EVR-242100A	42" Multi-Port MH, 8" Observation Port 12" Skirt, Diesel	SW, 5 gal	No Drain	None	N/A

*Custom configurations are available upon request*