



493508K A1004 Drain Kit

Parts Included:

493508K Drain Kit Assembly

Required Tools:

Needle Nose Pliers

493820 Emco Drain Wrench



Installation Instructions

1. Remove the old drain plug/drain valve from the bottom of spill container. If a drain plug is installed, remove using a 7/8" socket. If drain valve is installed, use a pair of needle nose pliers and remove both cotter pins and disassemble the linkage from the top of the drain valve assembly. Use the 493820 Drain Wrench to remove the drain valve assembly from the spill container.
2. Before installing the new drain valve assembly, clean and remove all dirt and debris from the bottom of the spill container. Verify that the flat gasket is installed and secured properly.
3. Manually tighten the new drain valve assembly to avoid cross threading. Using the 493820 Drain Wrench, torque between 13 ft-lbs and 15 ft-lbs.

IMPORTANT: Do not use pipe thread sealant compound when installing the drain valve assembly.

4. Re-install the linkage and both cotter pins as shown. Verify that the drain valve opens and closes when pulling up on the chain.
5. Reattach the chain to the top expanding clamp bolt.

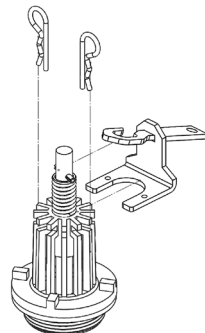

Emco Wheaton Retail Corp.

2300 Industrial Park Dr. • Wilson, North Carolina 27893
252-243-0150 • 252-243-4759 (fax)

p/n 568201
Rev. E 07/21